

THIS DRAWING IS THE PROPERTY OF DUBAI CONSULTANTS, ARCHITECTS, ENGINEERS & PLANNERS P.O. BOX 8185, DUBAI, U.A.E. WHO RESERVE ALL COPYRIGHTS. IT IS FORBIDDEN TO REPRODUCE ITS CONTENTS IN ANY FORM EXCEPT FOR THE PURPOSE FOR WHICH IT IS INTENDED.

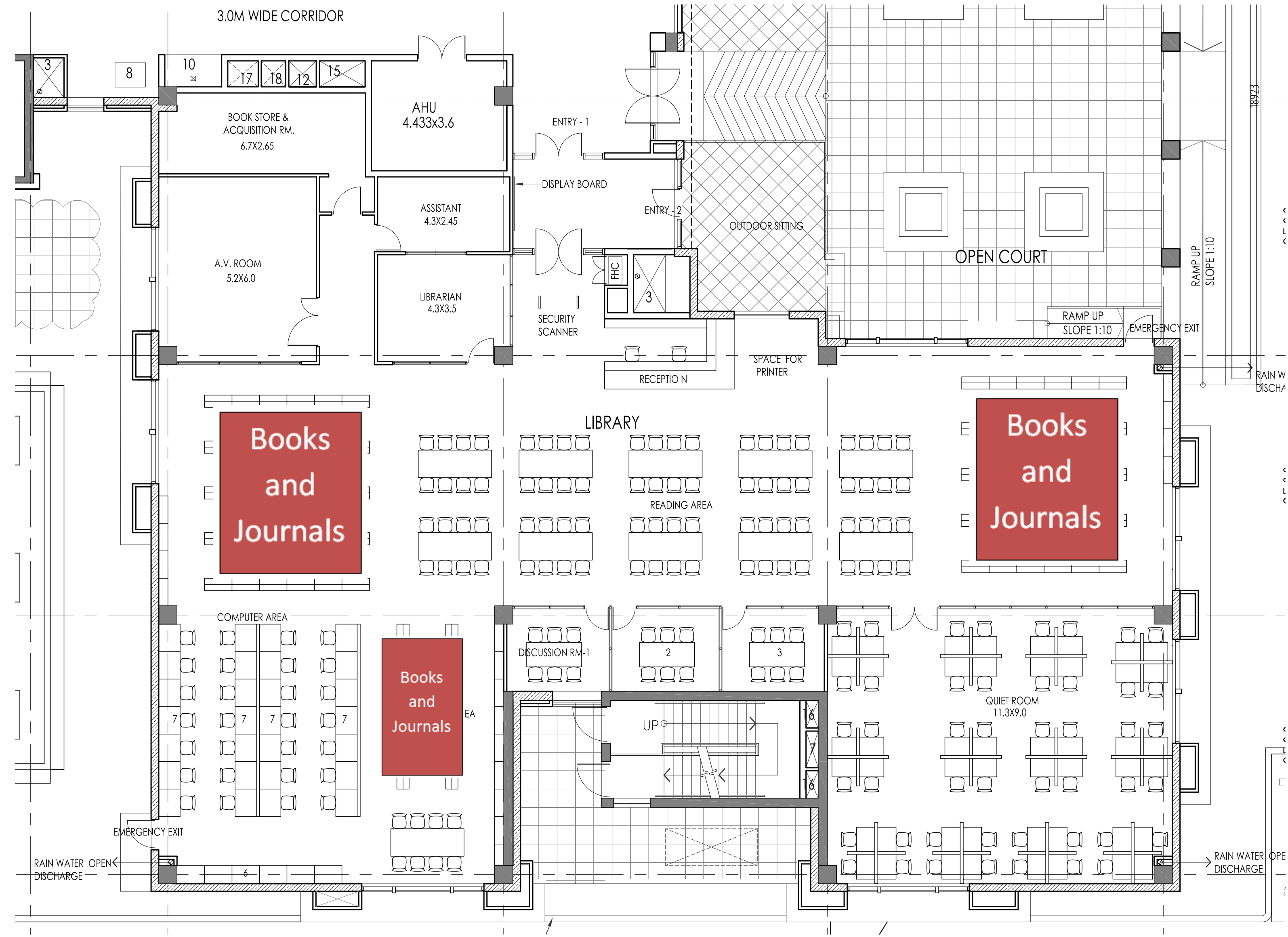

1. DO NOT SCALE THE DRAWINGS. FOLLOW WRITTEN DIMENSIONS IN MM UNLESS OTHERWISE MENTIONED. ALL THE LEVELS ARE IN MTS. UNLESS OTHERWISE SPECIFIED.
2. EACH DRAWING SHALL BE READ IN CONJUNCTION WITH ALL OTHER DRAWINGS & THE GENERAL STANDARD DETAILS. IN CASE OF ANY DISCREPANCIES BRING IT TO THE KNOWLEDGE OF ARCHITECT/ENGINEER.
3. DIMENSIONS SHOWN ON THESE DRAWINGS ARE STRUCTURAL DIMENSIONS. UNLESS NOTED OTHERWISE.
4. FOR EXACT LOCATIONS OF STRUCTURAL ELEMENTS SUCH AS COLUMNS, BEAMS ETC. REFER STRUCTURAL DRAWINGS.
5. ALL CUTOUTS TO BE COORDINATED WITH SHOP DRAWINGS.

no.	date	initials	Description

Architects:

Architects • Engineers • Design Consultants
 P.O. Box 8185 Dubai, U.A.E.
 Tel: 3362431 Fax: 3362437
 E-Mail: info@dubaiconsultants.ae

MEP Consultant:

P.O. Box 119962 • DUBAI • UNITED ARAB EMIRATES
 TEL: +971 4 3400044 FAX: +971 4 3400044
 E-mail: info@proled.com.ae • WWW.PROLED.COM.AE

Project Title:
PROPOSED B+G+S UNIVERSITY CAMPUS ON PLOT NO. UG-05, DUBAI ACADEMIC CITY FOR EKON INTERNATIONAL HOLDING FZ-LLC

Drawing Title:
PROPOSED LIBRARY LAYOUT

Scale(s)	Date	Job no.
1:100	13.05.10	EH-906
Drawn	Checked	Drawing no.
AD		
Cad file ref.	Approved	



Rev. RO